

Zeichnung Modell SX41415 mit Gegenstecker // Drawing Model SX41415 with mating Connector

Datum : 20.03.2017

Amos Ref. Nr. : 4161

Modell : SX 41415 AIM - 72 - 5,75 (+/- 5,75°)

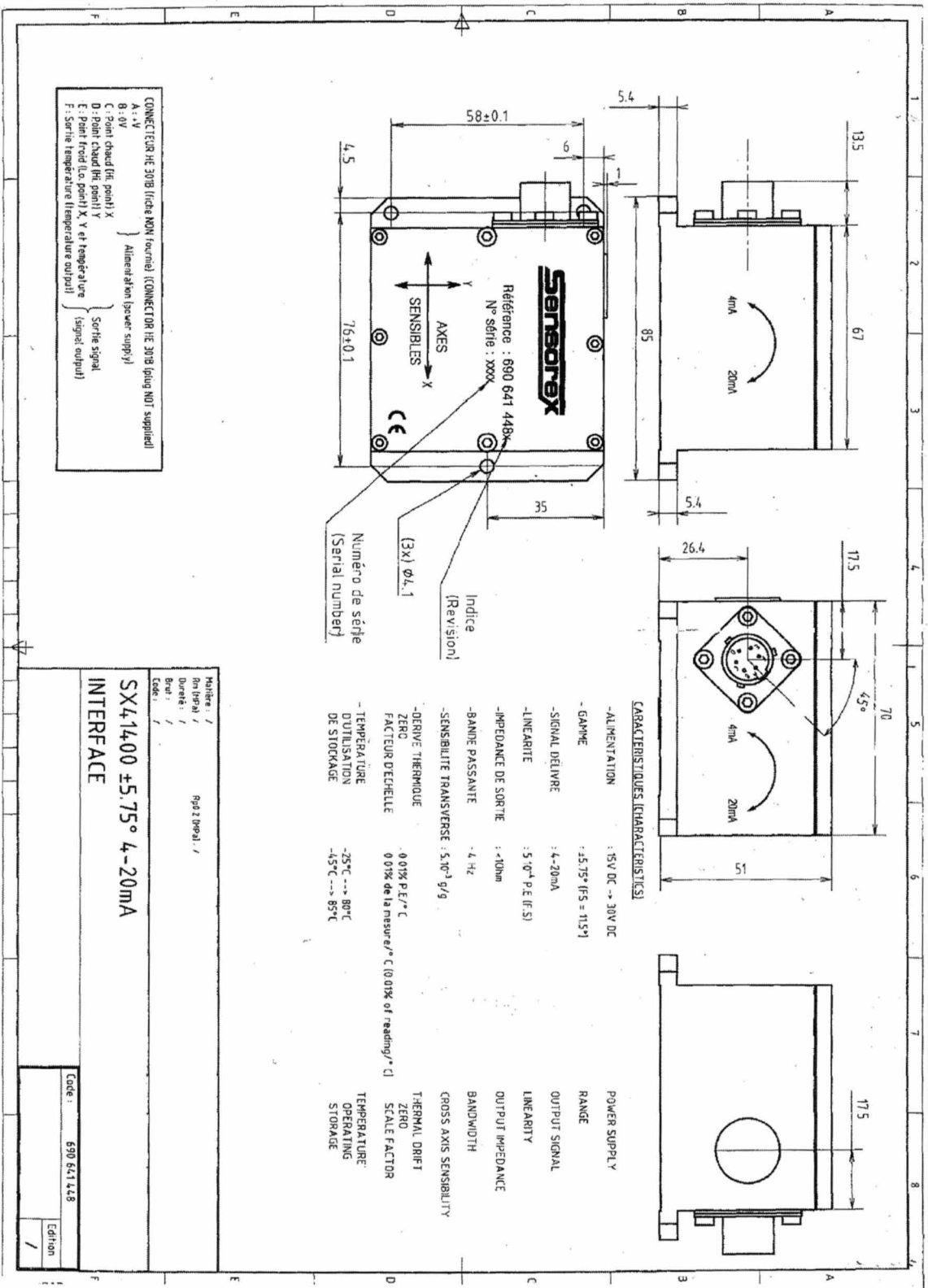

CARACTERISTIQUES (CHARACTERISTICS)

- ALIMENTATION	: 15V DC -> 30V DC	POWER SUPPLY
- GAMME	: ±5.75° (FS = 11.5°)	RANGE
- SIGNAL DELIVRE	: 4-20mA	OUTPUT SIGNAL
- LINEARITE	: 5.0° p.e.f.s	LINEARITY
- IMPEDANCE DE SORTIE	: <10ohm	OUTPUT IMPEDANCE
- BANDE PASSANTE	: 4 Hz	BANDWIDTH
- SENSIBILITE TRANSVERSE	: 5.10 ⁻³ g/g	CROSS AXIS SENSIBILITY
- DERIVE THERMIQUE ZERO	: 0.01% p.e./°C	THERMAL DRIFT
- FACTEUR D'EGHELLE	: 0.01% de la mesure/°C (0.01% of reading/°C)	SCALE FACTOR
- TEMPERATURE D'UTILISATION DE STOCKAGE	: -25°C -> 80°C -45°C -> 85°C	TEMPERATURE OPERATING STORAGE

Modèle / Output / Page 2 (Page 1 /) /

Donnée / /

Revis / /

Code / /

SX41400 ±5.75° 4-20mA

INTERFACE

Code : 690 641 448

Edition / /

English

Signal	PIN	Color
+ V Supply	A	red
0 V Supply	B	blue
+ Output " X " Axis	C	green
+ Output " Y " Axis	D	white
- Output " X + Y " Axis	E	black
Not Connected	F	yellow

Deutsch

Signal	PIN	Farbe
+ V Speisung	A	rot
0 V Speisung	B	blau
+ Ausgang " X " Achse	C	grün
+ Ausgang " Y " Achse	D	weiß
- Ausgang " X + Y " Achse	E	schwarz
Nicht anschließen	F	gelb