

[Linea **Micro S**]

Kettenantriebe für:
Klappfenster, Kippfenster,
Dachflächenfenster.

Chain actuator for:
top hinged windows, bottom
hinged windows, roof
windows.

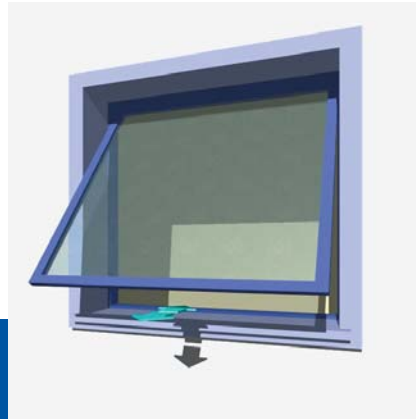

200N

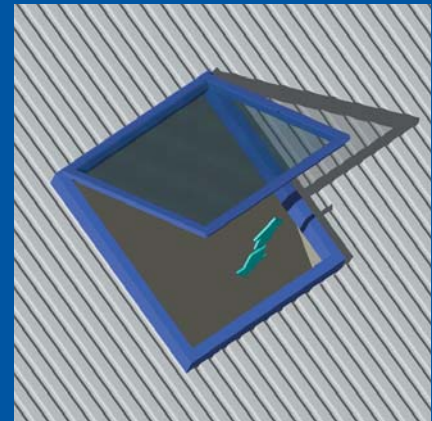

Sehr kleine Bauform
Very reduced dimensions

Verstärkte Kette
Double-link chain

Geringe Stromaufnahme
Low consumption

Wartungsfrei
Maintenance free

Schutzgrad: IP 20 / *Protection degree IP 20*

Endabschaltung Auf/Zu: Elektronisch-Verbrauch / *Limit switch closing-opening: Electronic-Absorption*

Farbe: Silbereloxiert (A) - Schwarzeloxiert (N) - RAL 9016 (B)
Colour: Anodised silver (A) - Anodised black (N) - RAL 9016 (B)

TECHNISCHE DATEN / TECHNICAL FEATURES

| BEST-NR CODE | BEZEICHNUNG DESCRIPTION | STEUERSPANNUNG VOLTAGE | SCHUBKRAFT ZUGKRAFT THRUST TENSILE | HUB STROKE | LEISTUNG MAX CONSUMPTION MAX | GESCHWINDIGKEIT MIN. SPEED MIN. |
|-----------------|----------------------------|---------------------------|---|---------------|---------------------------------------|--|
| 2700115 | Micro S 200 mm - (A) | 230 V~ / 50 Hz | 200 N | 200 mm | 30 W | ca. 10 mm/s |
| 2700552 | Micro S 200 mm - (N) | 230 V~ / 50 Hz | 200 N | 200 mm | 30 W | ca. 10 mm/s |
| 2700327 | Micro S 200 mm - (B) | 230 V~ / 50 Hz | 200 N | 200 mm | 30 W | ca. 10 mm/s |
| 2700055 | Micro S 250 mm - (A) | 230 V~ / 50 Hz | 200 N | 250 mm | 30 W | ca. 10 mm/s |
| 2700567 | Micro S 250 mm - (N) | 230 V~ / 50 Hz | 200 N | 250 mm | 30 W | ca. 10 mm/s |
| 2700328 | Micro S 250 mm - (B) | 230 V~ / 50 Hz | 200 N | 250 mm | 30 W | ca. 10 mm/s |
| 2700116 | Micro S 200 mm - (A) | 24 V = | 200 N | 200 mm | 20 W | ca. 10 mm/s |
| 2700562 | Micro S 200 mm - (N) | 24 V = | 200 N | 200 mm | 20 W | ca. 10 mm/s |
| 2700329 | Micro S 200 mm - (B) | 24 V = | 200 N | 200 mm | 20 W | ca. 10 mm/s |
| 2700117 | Micro S 250 mm - (A) | 24 V = | 200 N | 250 mm | 20 W | ca. 10 mm/s |
| 2700578 | Micro S 250 mm - (N) | 24 V = | 200 N | 250 mm | 20 W | ca. 10 mm/s |
| 2700330 | Micro S 250 mm - (B) | 24 V = | 200 N | 250 mm | 20 W | ca. 10 mm/s |

DIE IN DER TABELLE ANGEFÜHRTE WERTE WURDEN BEI EINER BETRIEBSTEMPERATUR ZWISCHEN -10°/+40° UND EINER RELATIVEN LUFTFEUCHTIGKEIT VON 60% ERMITTELT.
THE VALUES INDICATED ON THE TABLE WERE RECORDED IN A CLIMATIC TEST CHAMBER AT OPERATING TEMPERATURES BETWEEN -10°C/+40°C WITH MAX 60% RELATIVE HUMIDITY.

PRODUKTBESCHREIBUNG:

Elektrischer Linearantrieb mit Gelenkkette.

Betriebsspannung 230V~ 50 Hz Entspricht den Richtlinien 2006/95 LVD, 2004/108 EMC. Betriebsspannung 24V DC Entspricht den Richtlinien 2004/108 EMC. Ausgestattet mit Hall-Elementen. Möglichkeit der Parallelschaltung. Erhältlich in den Farben: Silbereloxiert (A) - Schwarzeloxiert (N) - RAL 9016 (B).

DESCRIPTION OF SPECIFICATIONS

MINGARDI linear electric actuator with reinforced double-sprocket chain inside the actuator body. Operating voltage: 230V~ 50 Hz in conformity with Directives 2006/95 LVD - 2004/108 EMC. Operating voltage: 24V DC in conformity with Directive 2004/108 EMC. Outfitted with electronic limit switch system for opening and closing, which can be connected in parallel. Colours available: anodised silver (A) - anodised black (N) - RAL 9016 (B).

Micro S Masszeichnungen / Scale drawing

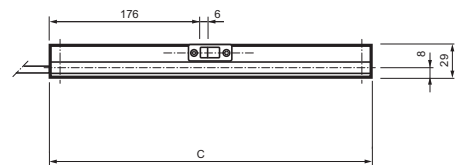
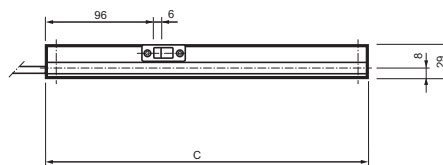
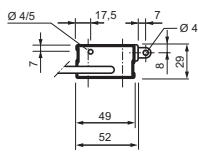
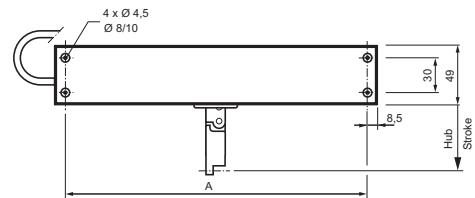
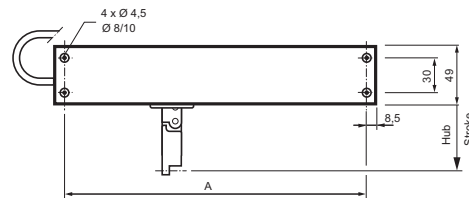

VERSION 24V CC
24V DC VERSION

| Hub/Stroke | A | C |
|------------|-----|-------|
| 200 | 224 | 261,4 |
| 250 | 269 | 286,4 |

VERSION 230V AC
230V AC VERSION

| Hub/Stroke | A | C |
|------------|-----|-----|
| 200 | 324 | 341 |
| 250 | 349 | 366 |

Zubehör und Ersatzteile / Accessories - Spare parts

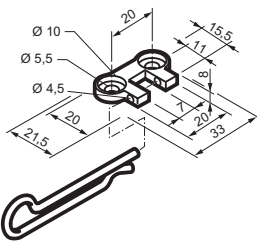

2700093

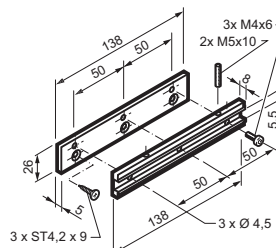

2700094

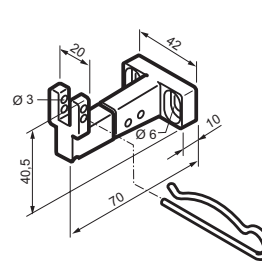

2700096

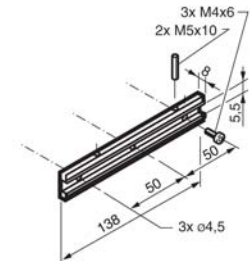

2700080

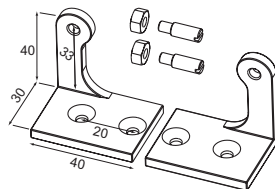
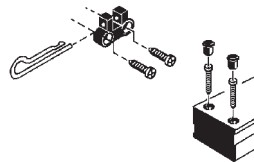

MONTAGEZUBEHÖR / FIXING ACCESSORIES

| BEST-NR CODE | BEZEICHNUNG DESCRIPTION |
|-----------------|---|
| 2700093 | Konsolensatz für Klappfenster Universal kit for fitting top-hinged windows |
| 2700094 | Konsolensatz für Kippfenster Universal kit for fitting bottom-hinged windows |
| 2700096 | Konsolensatz für Dachflächenfenster Universal kit for fitting roof windows |
| 2700080 | Drehbare Antriebskonsole Pivoting bracket for horizontal plane applications |

ERSATZTEILE / SPARE PARTS

| BEST-NR CODE | BEZEICHNUNG DESCRIPTION |
|-----------------|----------------------------|
| | |
| | |

STEUERZUBEHÖR: bitte wenden Sie sich an unseren technischen Kundendienst
CONTROL ACCESSORIES: please contact our technical support service for further information