



# SLP series - Slicer ( Polyethylene resin )

## Specification and External dimension

CHELIC PNEUMATIC



**CJ-M**  
Float joint

**M□V**  
Manually operated valve

**SA□**  
Shock absorber

**SHR**  
Hydraulic regulator

**SL□**  
Silencer

**P□S**  
Rod end

### Specification

Item	Model	SLP-01	SLP-02	SLP-02L	SLP-03	SLP-04	SLP-06	SLP-10
Fluid		Air						
Range of service pressure	kgf/cm <sup>2</sup> (kpa)	0 ~ 9 ( 900 )						
Ensure withstanding pressure	kgf/cm <sup>2</sup> (kpa)	11 ( 1100 )						
Range of service temperature	°C	5~60						
Material	Body	Polyethylene resin						
	Filter element	Foam resin (5μm)						
Connection port	Rc (PT)	1/8"	1/4"		3/8"	1/2"	3/4"	1 "

### External dimension

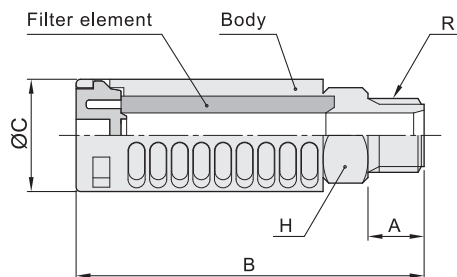

Model	Code	Connection port R Rc (PT)	A	B	C	Cross flat distance H
SLP - 01		1/8"	7	34	16	14
SLP - 02		1/4"	10	37	16	14
SLP - 02L		1/4"	10	62	20	16.8
SLP - 03		3/8"	12	67	26	24
SLP - 04		1/2"	15	70	28	24
SLP - 06		3/4"	16	99.3	40	31.5
SLP - 10		1 "	19	119	47.8	35.5

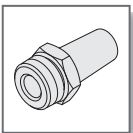

# SL series - Slinger ( Brass )

## Specification and External dimension

CHELIC PNEUMATIC



### 規格表

Item	Model	SL - M5	SL - 01	SL - 02	SL - 03	SL - 04	SL - 06
Fluid		Air					
Range of service pressure	kgf/cm <sup>2</sup> (kpa)	0 ~ 9 ( 900 )					
Ensure withstanding pressure	kgf/cm <sup>2</sup> (kpa)	13 ( 1300 )					
Range of service temperature	°C	5 ~ 60					
Material	Body	Brass					
	Filter element	Brass ( The thick of air pass through position 60μm )					
Connection port	Rc (PT)	M5 x 0.8p	1/8"	1/4"	3/8"	1/2"	3/4"
Weight	g	3	55			60	68

### External dimension

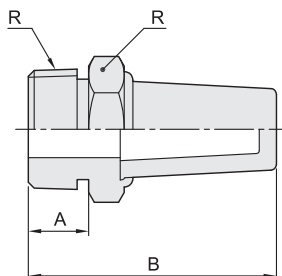

Model	Code	Connection port R Rc (PT)	A	B	Cross flat distance H
SL - M5		M5	5	18	8
SL - 01		1/8"	6	23	12
SL - 02		1/4"	8	29	16
SL - 03		3/8"	9	35	18
SL - 04		1/2"	10	43	22
SL - 06		3/4"	10	50	30

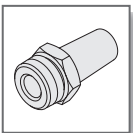

# SLB series - Silencer ( Brass )

## Specification and External dimension

CHELIC PNEUMATIC

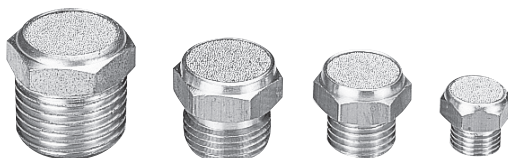

**CJ-M**  
Float joint

**M□V**  
Manually  
operated  
valve

**SA□**  
Shock  
absorber

**SHR**  
Hydraulic  
regulator

**SL□**  
Silencer

**P□S**  
Rod end

### Specification

Item	Model	SLB - M5	SLB - 01	SLB - 02	SLB - 03	SLB - 04
Fluid		Air				
Range of service pressure	kgf/cm <sup>2</sup> (kpa)	0 ~ 9 ( 900 )				
Ensure withstanding pressure	kgf/cm <sup>2</sup> (kpa)	13 ( 1300 )				
Range of service temperature	°C	5 ~ 60				
Material	Body	Brass				
	Filter element	Brass ( The thick of air pass through position 60μm)				
Connection port	Rc (PT)	M5x0.8P	1/8"	1/4"	3/8"	1/2"
Weight	g	3	55			60

### External dimension

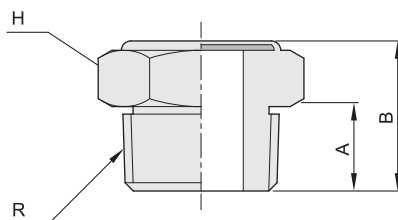

Model	Code	Connection port R Rc (PT)	A	B	Cross flat distance H
SLB - 01		1/8"	6	11.4	12
SLB - 02		1/4"	8.2	14.5	16
SLB - 03		3/8"	9	16	18
SLB - 04		1/2"	10.5	18	22

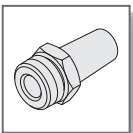

## SLR series - Slinger ( Brass )

### Specification and External dimension

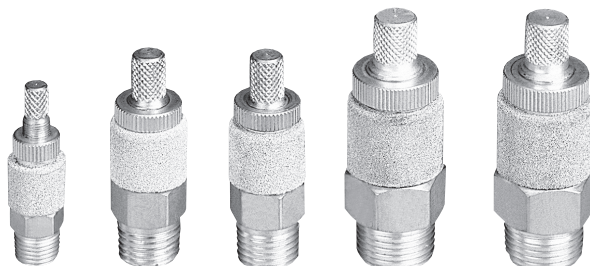

#### Specification

Item	Model	SLR - 01	SLR - 02	SLR - 03
Fluid		Air		
Range of service pressure	kgf/cm <sup>2</sup> (kpa)	0 ~ 9 ( 900 )		
Ensure withstanding pressure	kgf/cm <sup>2</sup> (kpa)	13 ( 1300 )		
Range of service temperature	°C	5 ~ 60		
Material	Body	Brass		
	Filter element	Brass ( The thick of air pass through position 60μm )		
Connection port	Rc (PT)	1/8"	1/4"	3/8"
Weight	g	55		

#### External dimension

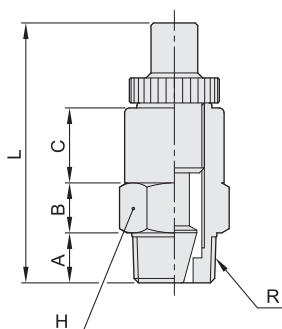

Model	Code	Connection port Rc (PT)	A	B	C	L	Cross flat distance H
SLR - 01		1/8"	7	7	10	38.2	9.9
SLR - 02		1/4"	9.7	7	12	44.6	14
SLR - 03		3/8"	10	10	15	52.6	19

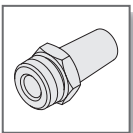

# SLBR series - Silencer ( Brass )

## Specification and External dimension

CHELIC PNEUMATIC

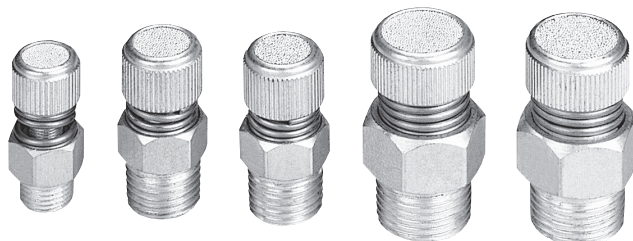

**CJ-M**  
Float joint

**M□V**  
Manually operated valve

**SA□**  
Shock absorber

**SHR**  
Hydraulic regulator

**SL□**  
Silencer

**P□S**  
Rod end

### Specification

Item	Model	SLBR - 01	SLBR - 02	SLBR - 03	SLBR - 04
Fluid		Air			
Range of service pressure	kgf/cm <sup>2</sup> (kpa)	0 ~ 9 ( 900 )			
Ensure withstanding pressure	kgf/cm <sup>2</sup> (kpa)	13 ( 1300 )			
Range of service temperature	°C	5 ~ 60			
Material	Body	Brass			
	Filter element	Brass ( The thick of air pass through position 60μm )			
Connection port	Rc (PT)	1/8"	1/4"	3/8"	1/2"
Weight	g	55		60	

### External dimension

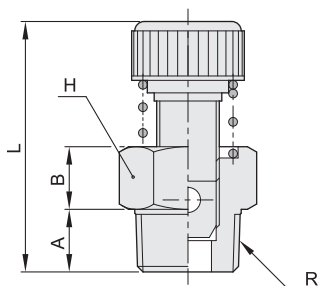

Model	Code	Connection port Rc (PT)	A	B	L		Cross flat distance H
					MIN	MAX	
SLBR - 01		1/8"	6	8	28	33	12
SLBR - 02		1/4"	9	12	30	35	16
SLBR - 03		3/8"	10	14	34	40	18
SLBR - 04		1/2"	10	20	36	42	22